

PERMIT REQUIRED

The installation, relocation or replacement of all fences in Omaha or within 3 miles of the city limits requires a permit from the City of Omaha - Permits and Inspection Division. Permit applications for chain link and split rail fences no more than 4' in height do not require the submittal of any drawings. All other fence permit applications require two (2) copies of a scale drawing of the entire lot. The drawing must indicate the name and location of adjacent streets. Indicate the location of the fence within the boundaries of the lot and add a note describing the *height* and kind of fence *material*. If material and labor costs are less than \$2,000, the permit fee is \$41. If the costs are greater than \$2,000, the fee will be higher.

TYPICAL FENCE PLAN

MIN. SIZE 8 1/2" x 11"

2 COPIES REQUIRED

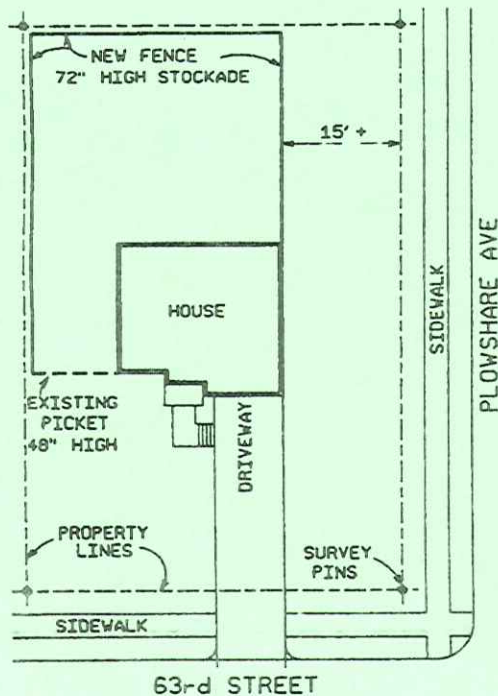

LOCATION RESTRICTED

All fences must be erected or constructed inside the surveyed property lines.

FACING

The fabric or finished surfaces of all fences must face toward the adjoining property or street frontage.

REQUIRED OPENINGS

To insure safety and visibility, any fence built on residential property within the required front or street side yards must have at least fifty (50) percent of the surface area open and unobstructed.

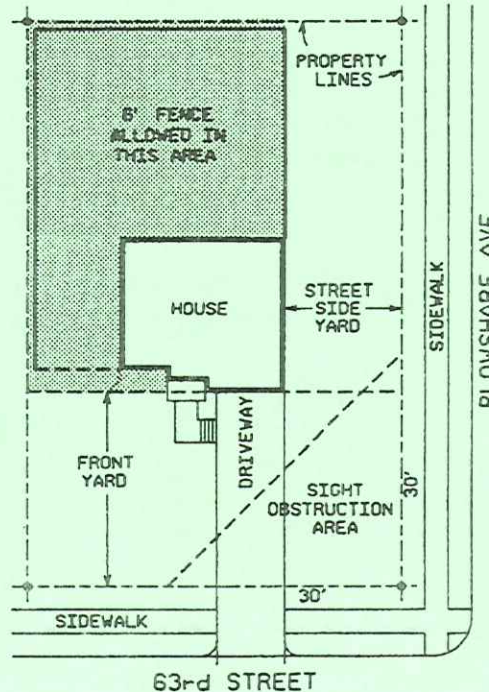

SIGHT OBSTRUCTION

No solid fence or screening may be installed within a triangle formed at the corner of two (2) intersecting streets and a line connecting points thirty (30) feet on each leg from corner of the lot.

RESIDENTIAL FENCES

Height: The maximum height allowed for a fence within a required front yard or street side yard setback is four (4) feet. The maximum height in the rear or side yard is six (6) feet.

Exception for street side yards: On corner lots, a fence built along the street side yard at the required setback may have a maximum height of six (6) feet.

Exception for front yards of double frontage lots: A fence built within a required front yard of a double frontage lot may be a maximum of six (6) feet in height and may exceed fifty (50) percent closed construction if the lot fronts a minor or major arterial street, expressway or freeway, and if the frontage does not provide primary access to the property.

OFFICE, COMMERCIAL AND INDUSTRIAL FENCES

Office and limited commercial districts: A fence in the LO-Limited Office, GO-General Office and LC-Limited Commercial districts may not exceed six (6) feet in height.

Commercial and industrial districts: The maximum height of a fence within a required front yard or street side yard setback is six (6) feet. The maximum height for a fence in the side or rear yard is ten (10) feet. These regulations may be modified by the planning director within landscaped buffer yards.

OTHER RESTRICTIONS

Barbed wire is not allowed except on fences surrounding cemeteries, public playgrounds or other places used for public recreation or amusement, public institutions, public utilities, factories, storage yards, or airports. In those cases it is permissible to string not more than three (3) strands of barbed wire on supports not less than six (6) feet above the ground, inclined at an angle not greater than sixty (60) degrees with the horizontal plane so that they are suspended above and within the property lines.

Fences required to enclose junkyards and auto salvage yards must be constructed to meet the requirements of Sections 30-85 and 55-786 of the Omaha Municipal Code.

It is unlawful to erect a chain link fence with the barbed salvage at its top.

Electric fences designed to control access by people or animals are not allowed. Exception: In AG and DR districts electric fences may be used to control the ranging of livestock.

Additional regulations may also apply

FOR MORE INFORMATION CALL:

PERMITS AND INSPECTION
444-5350
PLANNING DEPARTMENT
444-3426

September 2003

City of Omaha
Planning Department
Omaha/Douglas Civic Center
1819 Farnam Street
Omaha, Nebraska 68183-0114

FENCE PERMIT REQUIREMENTS

